



Well Cottage Denwood Street

Crundale, Canterbury, CT4 7EF

£2,750 Per Month

Surrounded by the stunning countryside of the North Downs is this beautiful family home, lovingly improved and extended.

Blending contemporary convenience with period features, this delightful detached house comprises an inviting entrance hall, sitting room with wood burning stove, open plan kitchen/dining room with impressive roof lanterns, study, utility and cloakroom. To the first floor are four double bedrooms, en suite dressing room and shower along with a spacious family bathroom.

Sitting in around 1/3 of an acre with beautifully landscaped gardens, generous gravelled driveway providing plenty of off road parking and oak framed car port.

Available now

Security Deposit £3173.00

EPC rating D

Council Tax band G

- STUNNING DETACHED FAMILY HOME
- PEACEFUL VILLAGE SETTING
- SET IN OVER 1/3 OF AN ACRE WITH LANDSCAPED GARDENS
- FOUR DOUBLE BEDROOMS
- EN SUITE DRESSING & SHOWER ROOM
- IMPRESSIVE KITCHEN/DINING ROOM EXTENSION
- 25FT SITTING ROOM WITH WOOD BURNING STOVE
- CARPORT & GENEROUS DRIVEWAY
- STUDY & UTILITY

Viewing

Please contact our Ashford Office on 01233 646411 if you wish to arrange a viewing appointment for this property or require further information.



Floor Plan

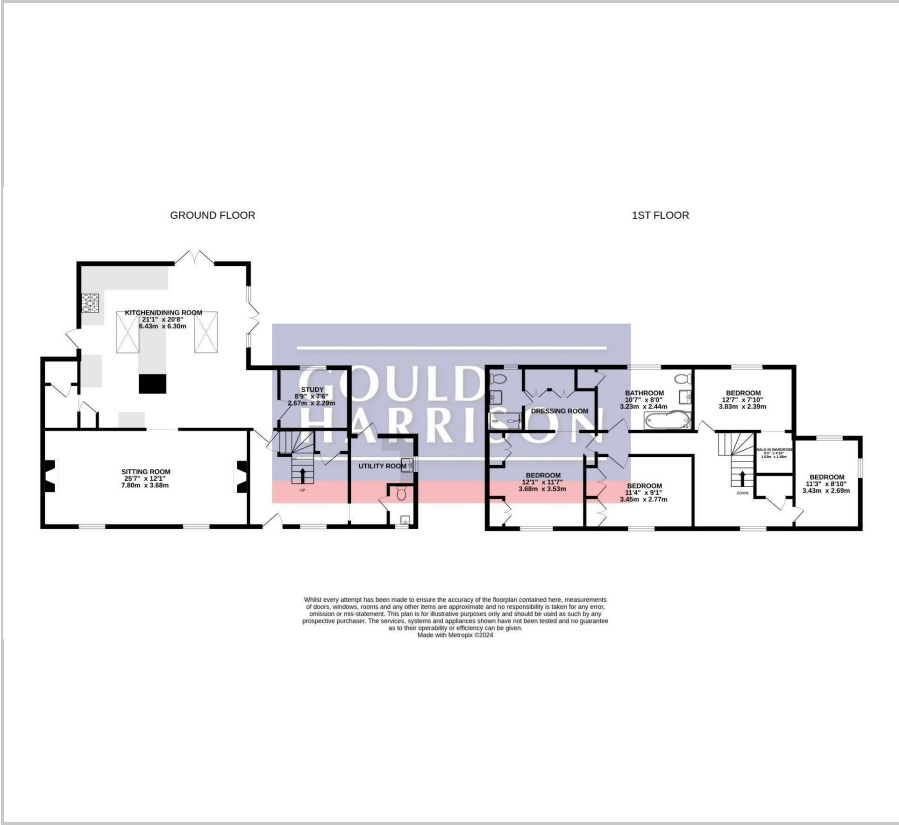

Area Map



Energy Efficiency Graph

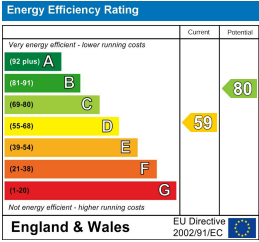

These particulars, whilst believed to be accurate are set out as a general outline only for guidance and do not constitute any part of an offer or contract. Intending purchasers should not rely on them as statements of representation of fact, but must satisfy themselves by inspection or otherwise as to their accuracy. No person in this firms employment has the authority to make or give any representation or warranty in respect of the property.